

## 2. Model options

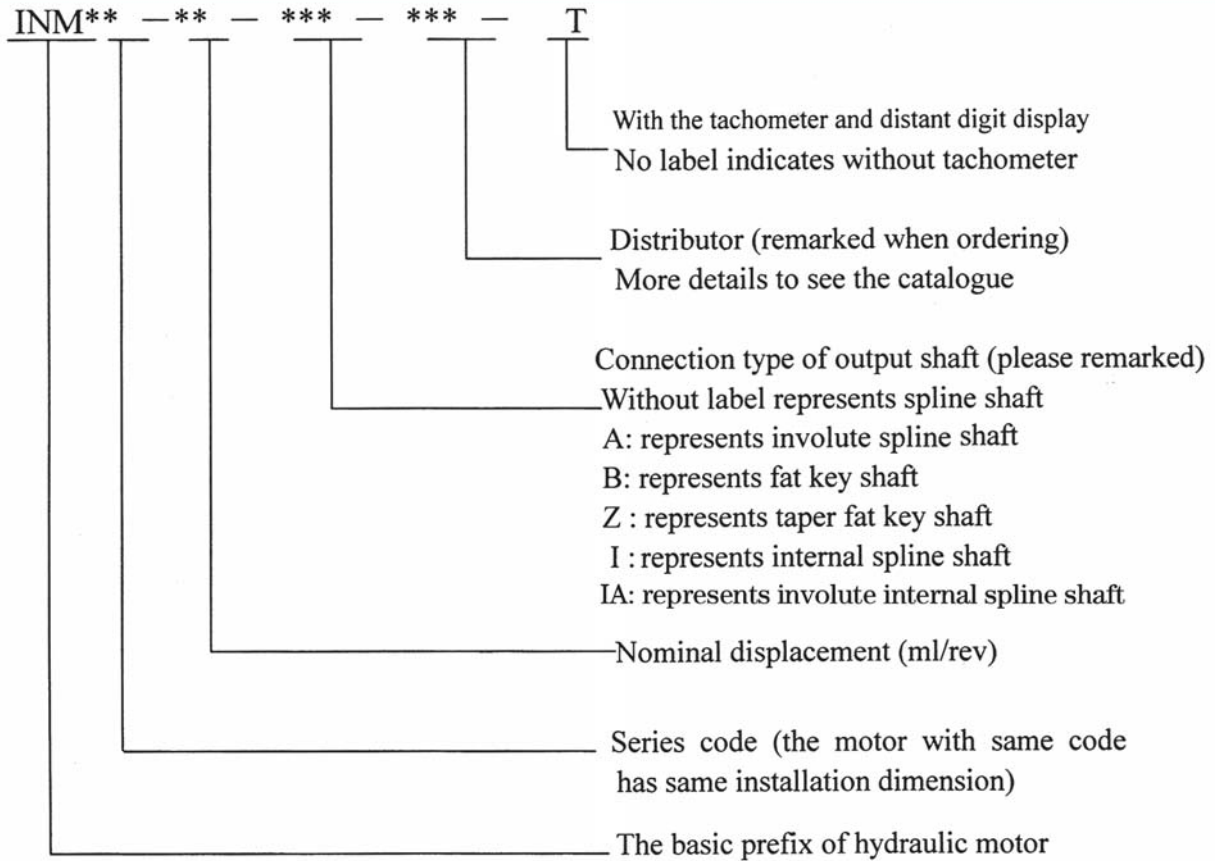

## 3. Options example

INM2-400BD31 represents that the motor is the 2 series unit of INM hydraulic motor. The nominal displacement is 400ml/rev, the output shaft is flat key shaft, and distributor model is D31 without tachometer. Please fill in the complete code options when ordering. If there are any specific requests, please noted in detail in delivery contract or contact our company

#### 4. INM系列液压马达技术参数

| 型号<br>TYPE | 理论排量<br>(ml/r)<br>THEORIC DISPLACEMENT | 额定压力<br>(MPa)<br>RATED PRESSURE | 尖峰压力<br>(MPa)<br>PEAK PRESSURE | 额定扭矩<br>(N·m)<br>RATED TORQUE | 单位扭矩<br>(N·m/Mpa)<br>SPECIFIC TORQUE | 连续转速<br>(r/min) |            | 重量<br>(kg)<br>WEIGHT |
|------------|--|---------------------------------|--------------------------------|-------------------------------|--------------------------------------|-----------------|------------|----------------------|
|            |  |                                 |                                |                               |                                      | CONT SPEED      | Max. SPEED |                      |
| INM05-60   | 59                                     | 25                              | 45                             | 235                           | 9.4                                  | 1~700           | 1000       | 22                   |
| INM05-75   | 74                                     | 25                              | 42.5                           | 295                           | 11.8                                 | 1~700           | 1000       |                      |
| INM05-90   | 86                                     | 25                              | 37.5                           | 343                           | 13.7                                 | 1~700           | 1000       |                      |
| INM05-110  | 115                                    | 25                              | 40                             | 458                           | 18.3                                 | 1~650           | 900        |                      |
| INM05-130  | 129                                    | 25                              | 37.5                           | 513                           | 20.5                                 | 1~650           | 900        |                      |
| INM05-150  | 151                                    | 25                              | 32.5                           | 600                           | 24                                   | 1~650           | 900        |                      |
| INM05-170  | 166                                    | 25                              | 32.5                           | 660                           | 26.4                                 | 1~600           | 800        |                      |
| INM05-200  | 191                                    | 25                              | 28                             | 760                           | 30.4                                 | 1~600           | 800        |                      |
| INM1-100   | 99                                     | 25                              | 42.5                           | 385                           | 15.4                                 | 1~550           | 1000       | 31                   |
| INM1-150   | 154                                    | 25                              | 40                             | 600                           | 24                                   | 1~550           | 1000       |                      |
| INM1-175   | 172                                    | 25                              | 37.5                           | 670                           | 26.8                                 | 1~550           | 900        |                      |
| INM1-200   | 201                                    | 25                              | 35                             | 785                           | 31.4                                 | 1~550           | 800        |                      |
| INM1-250   | 243                                    | 25                              | 35                             | 950                           | 38                                   | 1~450           | 700        |                      |
| INM1-300   | 290                                    | 25                              | 30                             | 1130                          | 45.2                                 | 1~350           | 650        |                      |
| INM1-320   | 314                                    | 25                              | 28                             | 1225                          | 49                                   | 1~350           | 600        |                      |
| INM1-350   | 340                                    | 25                              | 28                             | 1327                          | 53                                   | 1~300           | 600        |                      |
| INM2-200   | 192                                    | 25                              | 42.5                           | 750                           | 30                                   | 0.7~550         | 800        | 51                   |
| INM2-250   | 251                                    | 25                              | 42.5                           | 980                           | 39.2                                 | 0.7~550         | 800        |                      |
| INM2-300   | 304                                    | 25                              | 40                             | 1188                          | 47.5                                 | 0.7~500         | 750        |                      |
| INM2-350   | 347                                    | 25                              | 37.5                           | 1355                          | 54.2                                 | 0.7~500         | 750        |                      |
| INM2-420   | 425                                    | 25                              | 35                             | 1658                          | 66.3                                 | 0.7~450         | 750        |                      |
| INM2-500   | 493                                    | 25                              | 35                             | 1923                          | 76.9                                 | 0.7~450         | 700        |                      |
| INM2-600   | 565                                    | 25                              | 30                             | 2208                          | 88.3                                 | 0.7~450         | 700        |                      |
| INM2-630   | 623                                    | 25                              | 28                             | 2433                          | 97.3                                 | 0.7~400         | 650        |                      |
| INM3-425   | 426                                    | 25                              | 42.5                           | 1660                          | 66.4                                 | 0.5~500         | 650        | 87                   |
| INM3-500   | 486                                    | 25                              | 42.5                           | 1895                          | 75.8                                 | 0.5~450         | 600        |                      |
| INM3-600   | 595                                    | 25                              | 40                             | 2320                          | 92.8                                 | 0.5~450         | 575        |                      |
| INM3-700   | 690                                    | 25                              | 35                             | 2700                          | 108                                  | 0.5~400         | 500        |                      |
| INM3-800   | 792                                    | 25                              | 35                             | 3100                          | 124                                  | 0.5~400         | 500        |                      |
| INM3-900   | 873                                    | 25                              | 35                             | 3400                          | 136                                  | 0.5~350         | 400        |                      |
| INM3-1000  | 987                                    | 25                              | 28                             | 3850                          | 154                                  | 0.5~300         | 350        |                      |
| INM4-600   | 616                                    | 25                              | 40                             | 2403                          | 96.1                                 | 0.4~400         | 550        | 120                  |
| INM4-800   | 793                                    | 25                              | 40                             | 3100                          | 124                                  | 0.4~350         | 550        |                      |
| INM4-900   | 904                                    | 25                              | 37.5                           | 3525                          | 141                                  | 0.4~325         | 450        |                      |
| INM4-1000  | 1022                                   | 25                              | 35                             | 4000                          | 160                                  | 0.4~300         | 400        |                      |
| INM4-1100  | 1116                                   | 25                              | 35                             | 4350                          | 174                                  | 0.4~275         | 400        |                      |
| INM4-1300  | 1316                                   | 25                              | 28                             | 5125                          | 205                                  | 0.4~225         | 350        |                      |
| INM5-800   | 807                                    | 25                              | 42.5                           | 3150                          | 126                                  | 0.3~325         | 450        |                      |
| INM5-1000  | 1039                                   | 25                              | 42.5                           | 4050                          | 162                                  | 0.3~300         | 450        |                      |
| INM5-1200  | 1185                                   | 25                              | 40                             | 4625                          | 185                                  | 0.3~300         | 400        |                      |
| INM5-1300  | 1340                                   | 25                              | 40                             | 5225                          | 209                                  | 0.3~300         | 400        |                      |
| INM5-1450  | 1462                                   | 25                              | 37.5                           | 5700                          | 228                                  | 0.3~275         | 350        |                      |
| INM5-1600  | 1634                                   | 25                              | 37.5                           | 6350                          | 254                                  | 0.3~250         | 300        |                      |
| INM5-1800  | 1816                                   | 25                              | 35                             | 7075                          | 283                                  | 0.3~250         | 300        |                      |
| INM5-2000  | 2007                                   | 25                              | 35                             | 7825                          | 313                                  | 0.3~200         | 250        |                      |
| INM6-1700  | 1690                                   | 25                              | 45                             | 6600                          | 264                                  | 0.2~250         | 400        | 275                  |
| INM6-2100  | 2127                                   | 25                              | 40                             | 8300                          | 332                                  | 0.2~225         | 350        |                      |
| INM6-2500  | 2513                                   | 25                              | 35                             | 9800                          | 392                                  | 0.2~200         | 300        |                      |
| INM6-3000  | 3041                                   | 25                              | 30                             | 11875                         | 475                                  | 0.2~175         | 250        |                      |
| INM7-1200  | 1214                                   | 25                              | 30                             | 4125                          | 165                                  | 0.2~325         | 380        | 310                  |
| INM7-2000  | 2007                                   | 25                              | 35                             | 7975                          | 319                                  | 0.2~350         | 450        |                      |
| INM7-2500  | 2526                                   | 25                              | 35                             | 10050                         | 402                                  | 0.2~300         | 350        |                      |
| INM7-3000  | 2985                                   | 25                              | 35                             | 11877                         | 475                                  | 0.2~250         | 300        |                      |
| INM7-3300  | 3290                                   | 25                              | 35                             | 13075                         | 523                                  | 0.2~220         | 275        |                      |
| INM7-3600  | 3611                                   | 25                              | 32                             | 14350                         | 574                                  | 0.2~200         | 250        |                      |
| INM7-4300  | 4298                                   | 25                              | 30                             | 17100                         | 684                                  | 0.2~175         | 225        |                      |

5. INM05系列液压马达安装连接尺寸图及性能曲线

DIMENSIONS

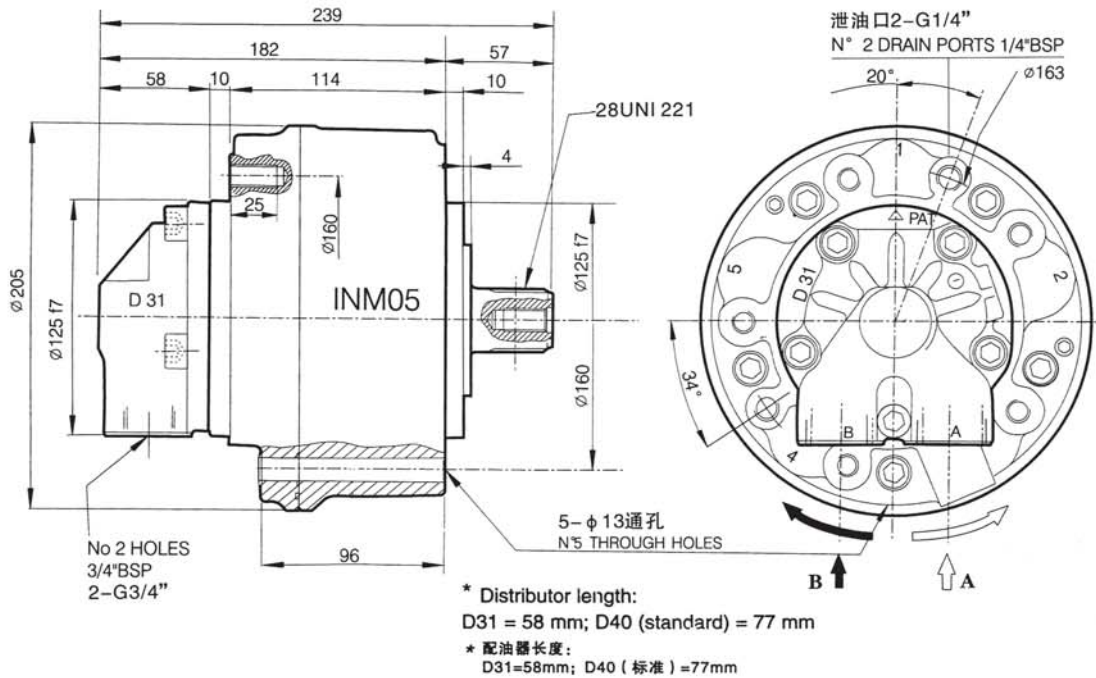

SHAFTS 轴伸型式

Splined  
矩形外花键

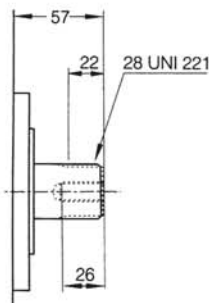

Splined A  
渐开线外花键 A

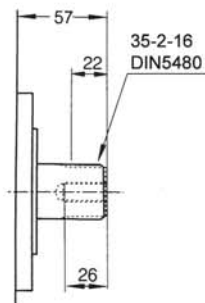

Cylindrical B  
圆柱平键 B

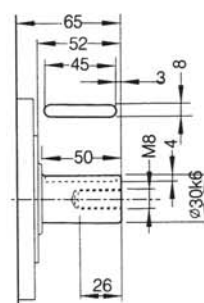

Internal spline I, IA  
内花键 I, IA

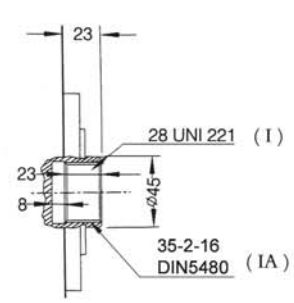

SPLINE DATA - 花键参数

| 35-2-16 DIN 5480 |   |
|------------------|---|
| d0               | ∅32.0                                       |
| d1               | ∅35.0 <sup>+0.520</sup> / <sub>+0</sub> H14 |
| d2               | ∅31.0 <sup>+0.160</sup> / <sub>+0</sub> H11 |
| A                | ∅3.5  |
| da               | ∅27.711 H11                                 |
| d3               | ∅34.6 <sup>-0</sup> / <sub>-0.160</sub> h11 |
| d4               | ∅30.6 <sup>-0</sup> / <sub>-0.520</sub> h14 |
| B                | ∅4.0  |
| db               | ∅39.000 f8                                  |

| 28 UNI 221(6-28-34) DIN 5463 |   |
|------------------------------|---|
| d1                           | ∅28.0 <sup>+0.021</sup> / <sub>+0</sub> H7      |
| d2                           | ∅34.1 <sup>+0.160</sup> / <sub>+0</sub> H11     |
| A                            | 7.0 <sup>+0.028</sup> / <sub>+0.013</sub> F7    |
| d3                           | ∅28.0 <sup>-0.007</sup> / <sub>-0.020</sub> g6  |
| d4                           | ∅34.0 <sup>-0.065</sup> / <sub>-0.160</sub> h14 |
| B                            | 7.0 <sup>-0.013</sup> / <sub>-0.026</sub> f7    |

ADAPTORS  
联轴器

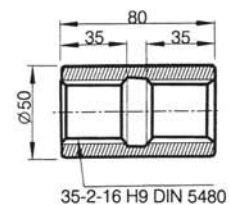

**PERFORMANCE**

The graphs indicate the typical performance characteristics of the **150cc** motor operating with mineral oil with viscosity 40 cSt at 50 °C.

**特性曲线**

下列图表为排量**150cc**的马达，在工作液采用矿物油，粘度40cSt,油温50℃工作时的典型特性曲线。

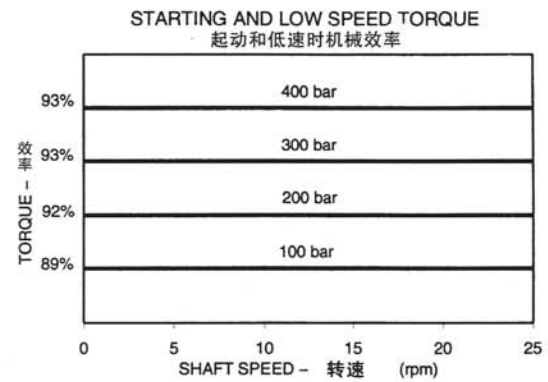
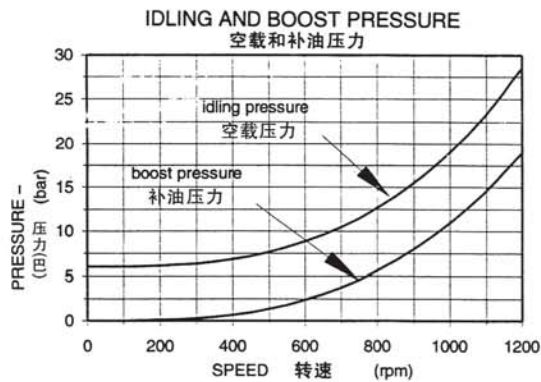
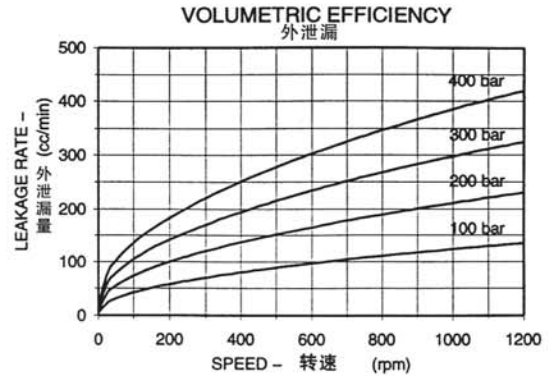
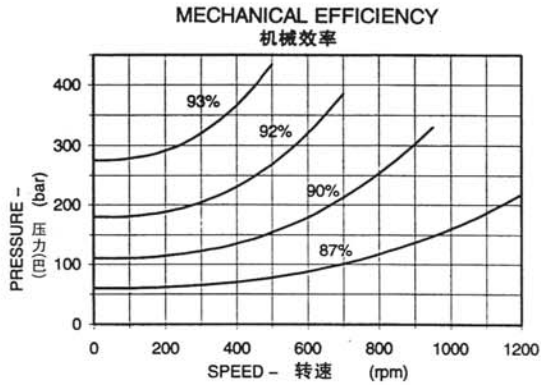

**BEARING LIFETIME**

The graph refers to the motor with the optional roller bearings (option H). Note that the average lifetime of a bearing ( $B_{50}$  lifetime) is approximately 5 times the  $B_{10}$  lifetime.

**轴承寿命**

该图表适用配置滚柱轴承（代号H）的马达。

注意轴承平均寿命（ $B_{50}$ 寿命）大约是 $B_{10}$ 寿命的5倍。

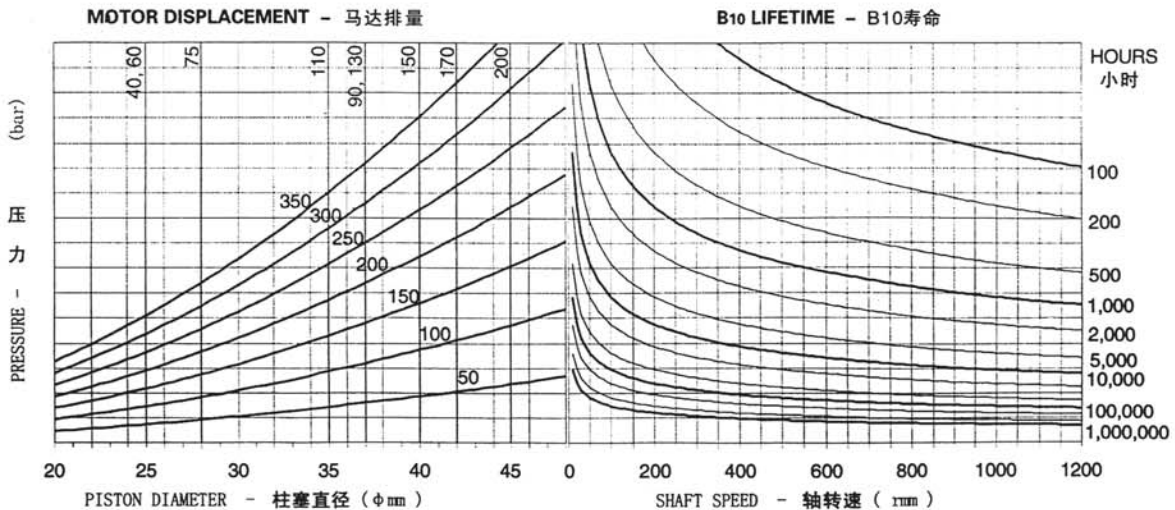

## 6. INM1系列液压马达 INM1 Series Hydraulic Motors

### DIMENSIONS

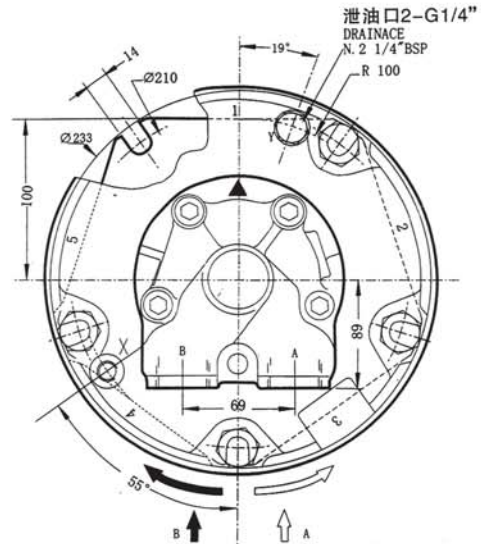
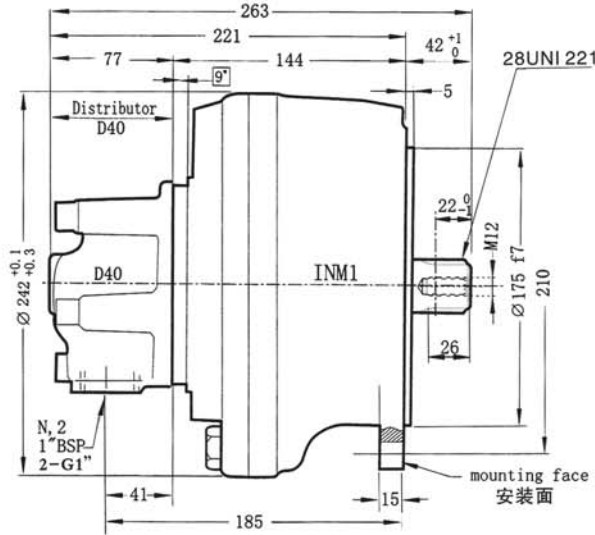

Flange and shaft dimensions are the same as for GM1, M1 and P1 series motors

法兰和轴承尺寸与GM1、M1和P1马达系列相同

### SHAFTS 轴伸型式

Splined  
矩形外花键

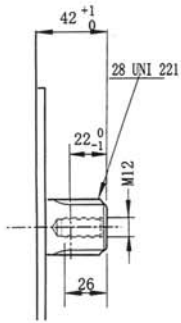

Splined A  
渐开线外花键 A

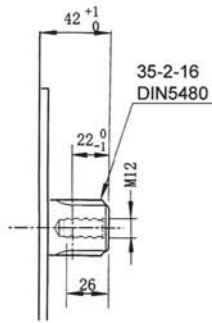

Cylindrical B  
圆柱平键 B

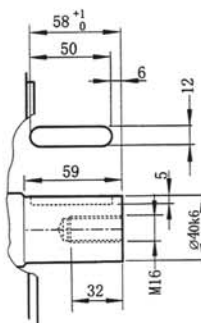

Internal spline I, IA  
内花键 I, IA

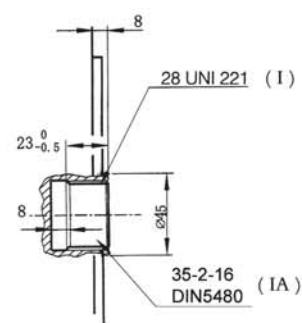

### SPLINE DATA - 花键参数

| 35-2-16 DIN 5480 |                                    | 28 UNI 221 (6-28-34 DIN 5463) |                                    |
|------------------|------------------------------------|-------------------------------|------------------------------------|
|                  | d0 $\varnothing 32.0$              |                               | d1 $\varnothing 28.0^{+0.021} H7$  |
|                  | d1 $\varnothing 35.0^{-0.520} H14$ |                               | d2 $\varnothing 34.1^{-0.160} H11$ |
|                  | d2 $\varnothing 31.0^{-0.160} H11$ |                               | A 7.0 <sup>+0.028</sup> F7         |
|                  | A $\varnothing 3.5$                |                               | d3 $\varnothing 28.0^{-0.007} g6$  |
|                  | da $\varnothing 27.711 H11$        |                               | d4 $\varnothing 34.0^{-0.065} h14$ |
|                  | d3 $\varnothing 34.6^{-0.160} h11$ |                               | B 7.0 <sup>-0.028</sup> f7         |
|                  | d4 $\varnothing 30.6^{-0.520} h14$ |                               |                                    |
|                  | B $\varnothing 4.0$                |                               |                                    |
|                  | db $\varnothing 39.000 f8$         |                               |                                    |

### ADAPTORS

联轴器

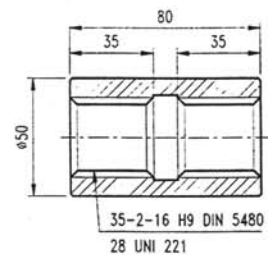

## PERFORMANCE

The graphs indicate the typical performance characteristics of the **150 cc** motor operating with mineral oil with viscosity 40 cSt at 50 °C.

## 特性曲线

下列图表为排量**150cc**的马达，在工作液采用矿物油，粘度40cSt,油温50°C工作时的典型特性曲线。

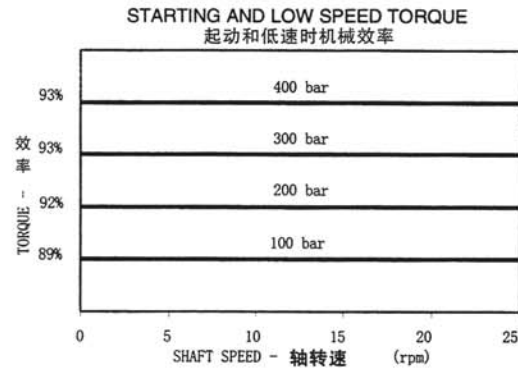
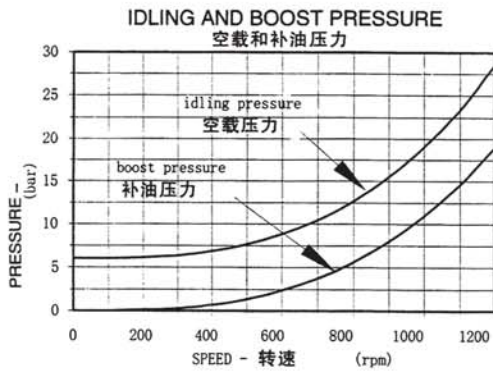
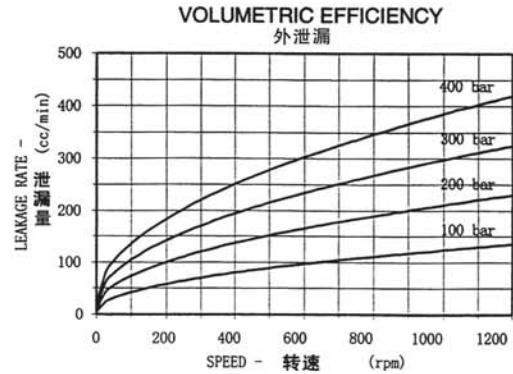
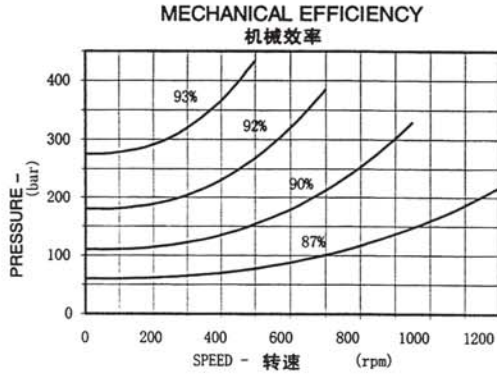

## BEARING LIFETIME

The graph refers to the motor with the optional roller bearings (option H) recommended for most applications. Note that the average lifetime of a bearing ( $B_{50}$  lifetime) is approximately 5 times the  $B_{10}$  lifetime.

## 轴承寿命

该图表适用配置滚柱轴承(代号H)的马达，大多数情况下推荐使用。注意轴承平均寿命( $B_{50}$ 寿命)大约是 $B_{10}$ 寿命的5倍。

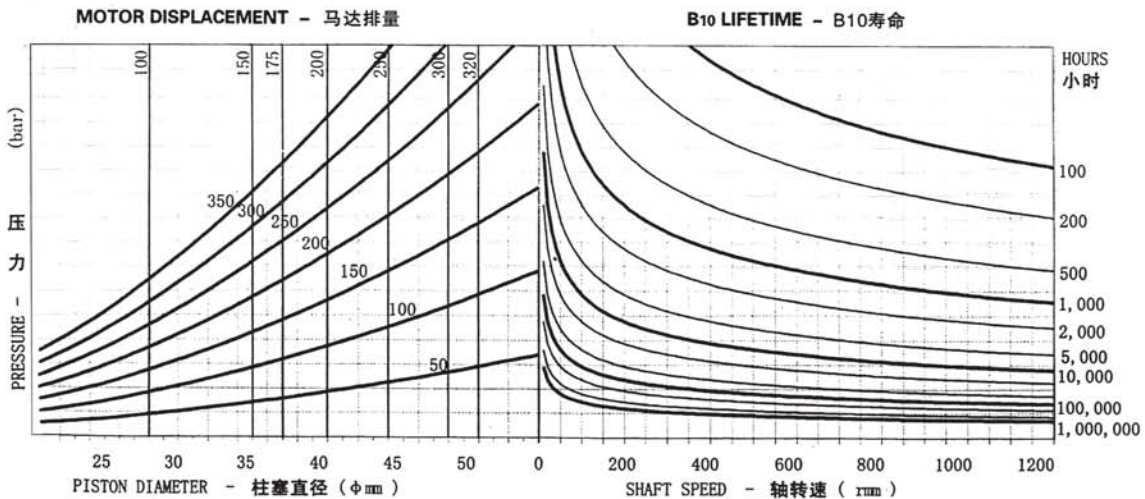

7. INM2系列液压马达 INM2 Series Hydraulic Motors

DIMENSIONS

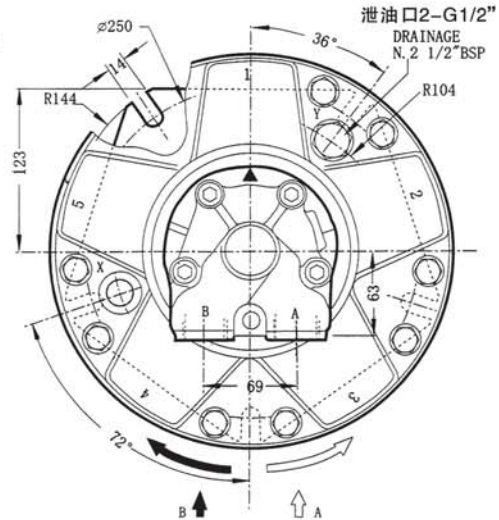
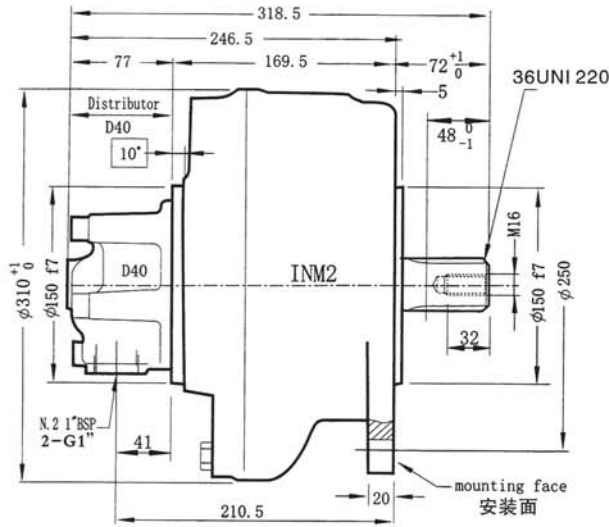

Flange and shaft dimensions are the same as for GM2, M3 and P3 series motors.

法兰和轴承尺寸与GM2、M3和P3马达系列相同

SHAFTS 轴伸型式

Splined  
矩形外花键

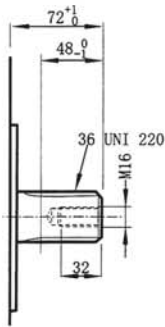

Splined A  
渐开线外花键 A

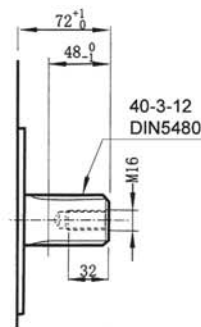

Cylindrical B  
圆柱平键 B

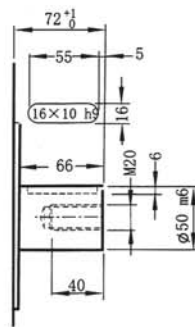

Internal spline I, IA  
内花键 I, IA

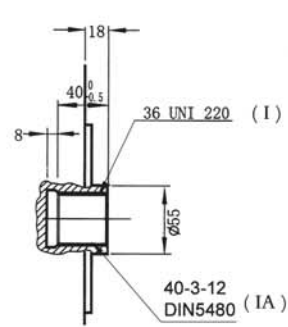

SPLINE DATA - 花键参数

| 40-3-12 DIN 5480 |                             |
|------------------|-----------------------------|
| d0               | ∅36.0                       |
| d1               | ∅40.0 <sup>+0.020</sup> H14 |
| d2               | ∅34.0 <sup>+0.160</sup> H11 |
| A                | ∅5.25                       |
| da               | ∅28.964 H11                 |
| d3               | ∅39.4 <sup>+0.099</sup> h11 |
| d4               | ∅33.4 <sup>+0.020</sup> h14 |
| B                | ∅6.0                        |
| db               | ∅45.989 f8                  |

| 36 UNI 220 (DIN 5462) |                             |
|-----------------------|-----------------------------|
| d1                    | ∅36.0 <sup>+0.025</sup> H7  |
| d2                    | ∅40.0 <sup>+0.160</sup> H11 |
| A                     | 7.0 <sup>+0.028</sup> F7    |
| d3                    | ∅36.0 <sup>-0.009</sup> g6  |
| d4                    | ∅40.0 <sup>-0.065</sup> d11 |
| B                     | 7.0 <sup>-0.028</sup> f7    |

ADAPTORS  
联轴器

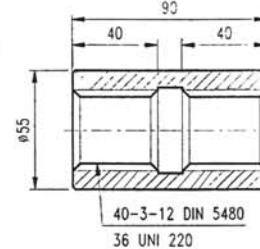

## PERFORMANCE

The graphs indicate the typical performance characteristics of the 300cc motor operating with mineral oil with viscosity 40 cSt at 50 °C.

## 特性曲线

下列图表为排量300cc的马达，在工作液采用矿物油，粘度40cSt,油温50℃工作时的典型特性曲线。

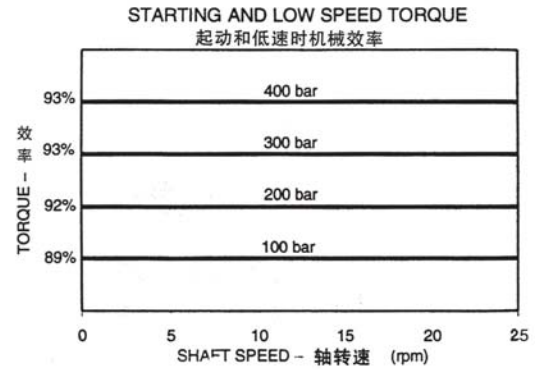
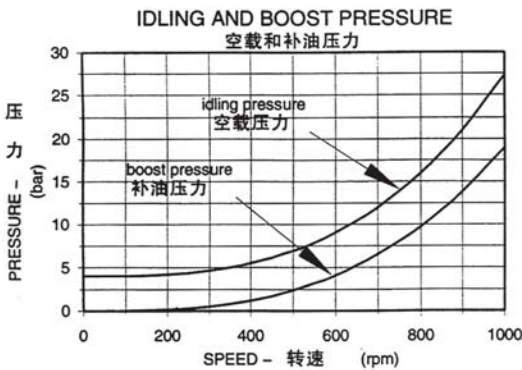
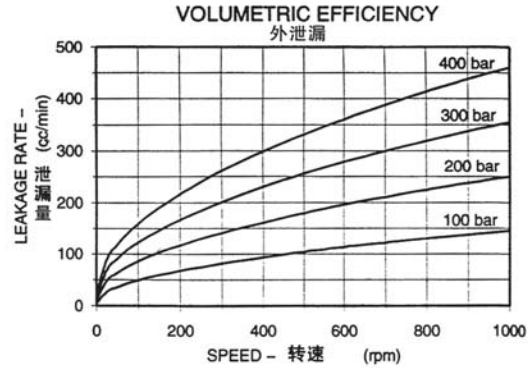
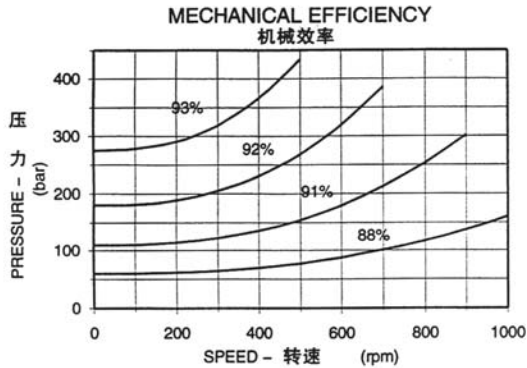

## BEARING LIFETIME

The graph refers to the motor with the optional roller bearings (option H) recommended for most applications. Note that the average lifetime of a bearing ( $B_{50}$  lifetime) is approximately 5 times the  $B_{10}$  lifetime.

## 轴承寿命

该图表适用配置滚柱轴承（代号H）的马达，大多数情况下推荐使用。  
注意轴承平均寿命（ $B_{50}$ 寿命）大约是 $B_{10}$ 寿命的5倍。

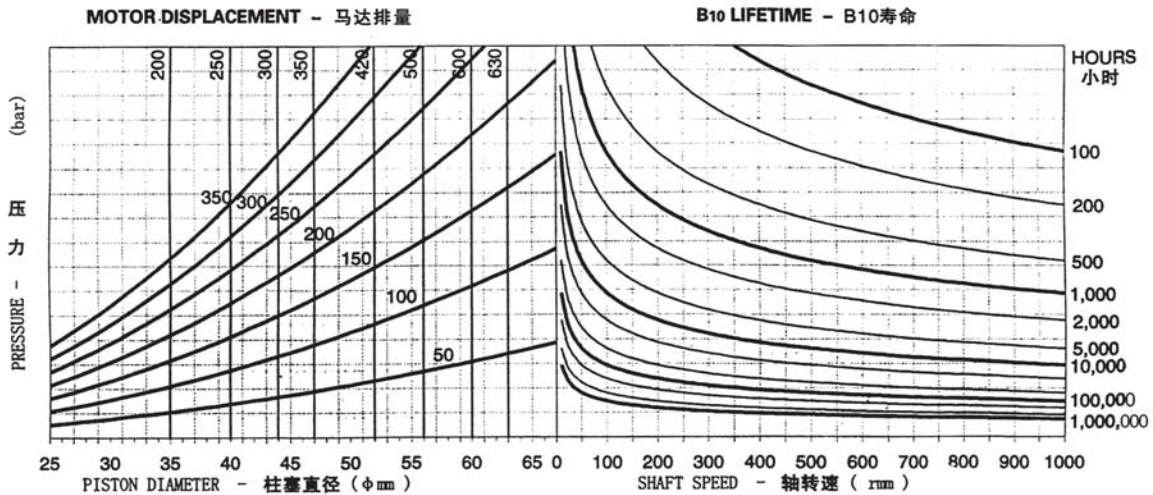



### 8. INM 3系列液压马达 INM3 Series Hydraulic Motors

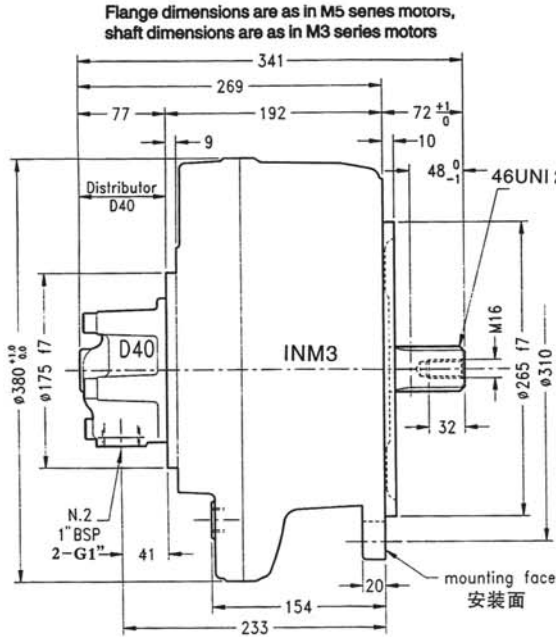

法兰和轴承尺寸与 M5系列马达系列相同。  
轴尺寸与M3系列马达相同。

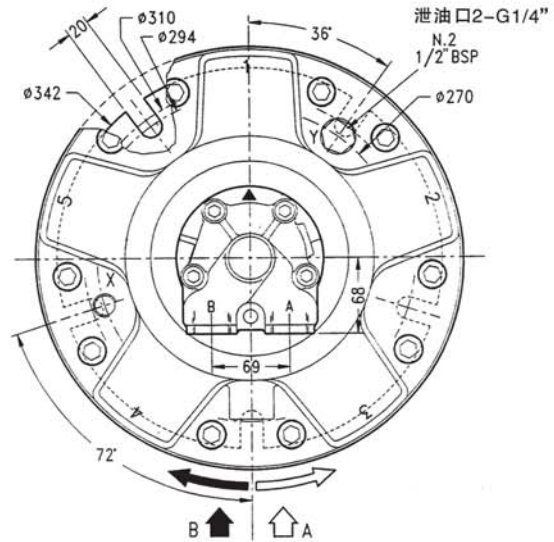

Available also GM3 completely interch.

外形尺寸尺寸完全适用GM3，

### SHAFTS 轴伸型式

Splined  
矩形外花键

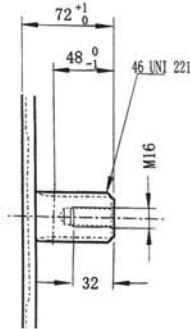

Splined A  
渐开线外花键 A

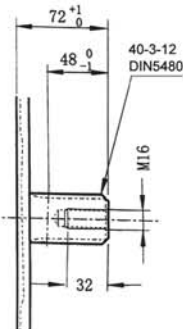

Cylindrical B  
圆柱平键 B

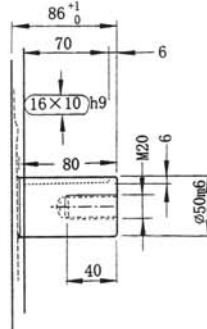

Internal spline I, IA  
内花键 I, IA

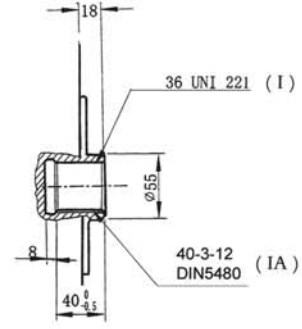

### SPLINE DATA - 花键参数

| 40-3-12 DIN 5480 |   | 46 UNI 221 (8-46-54 DIN 5463) |   |
|------------------|---|-------------------------------|---|
|                  | d0 $\varnothing 36.0$                   |                               | d1 $\varnothing 46.0^{+0.030}_{+0} H7$      |
|                  | d1 $\varnothing 40.0^{+0.020}_{+0} H14$ |                               | d2 $\varnothing 54.0^{+0.190}_{+0} H11$     |
|                  | d2 $\varnothing 34.0^{+0.160}_{+0} H11$ |                               | A 9.0 <sup>-0.028</sup> F7                  |
|                  | A $\varnothing 5.25$                    |                               | d3 $\varnothing 46.0^{+0.009}_{-0.025} g6$  |
|                  | da $\varnothing 28.964 H11$             |                               | d4 $\varnothing 54.0^{+0.100}_{-0.290} d11$ |
|                  | d3 $\varnothing 39.4^{+0}_{-0.160} h11$ |                               | B 9.0 <sup>-0.028</sup> f7                  |
|                  | d4 $\varnothing 33.4^{+0}_{-0.020} h14$ |                               |   |
|                  | B $\varnothing 6.0$                     |                               |   |
|                  | db $\varnothing 45.989 f8$              |                               |   |

### ADAPTORS

联轴器

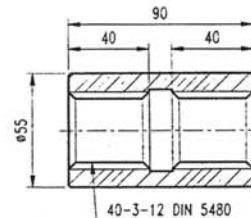

## PERFORMANCE

The graphs indicate the typical performance characteristics of the **600cc** motor operating with mineral oil with viscosity 40.cSt at 50 °C.

## 特性曲线

下列图表为排量**600cc**的马达，在工作液采用矿物油，粘度40cSt,油温50°C工作时的典型特性曲线。

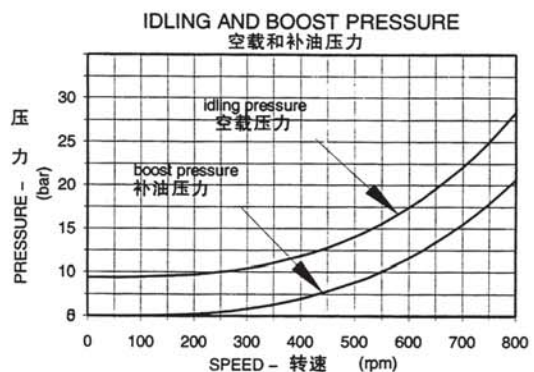
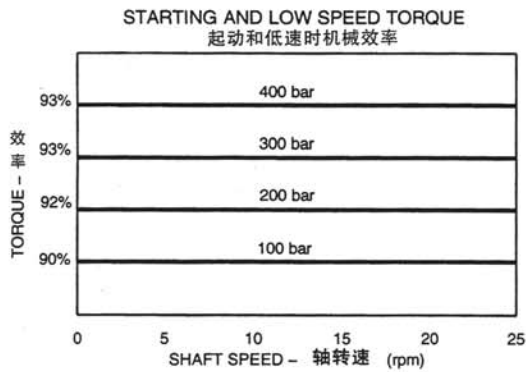
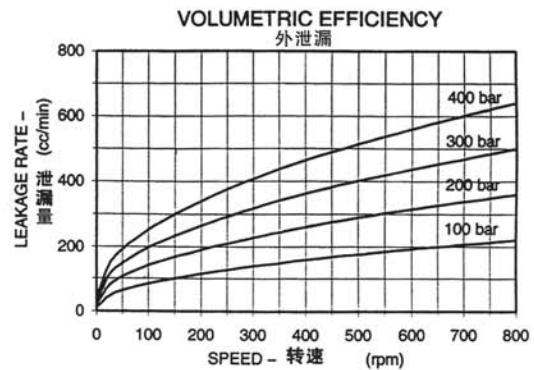
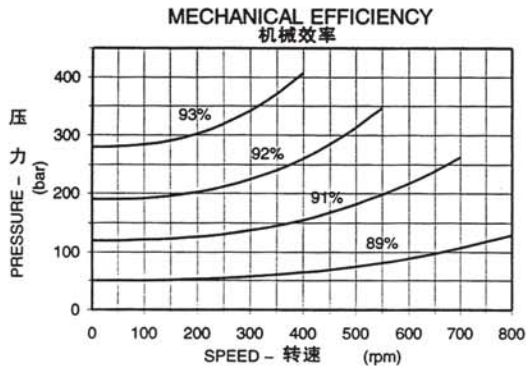

## BEARING LIFETIME

The graph refers to the motor with the standard roller bearings.  
Note that the average lifetime of a bearing ( $B_{50}$  lifetime) is approximately 5 times the  $B_{10}$  lifetime.

## 轴承寿命

该图表适用配置滚柱轴承的马达。

注意轴承平均寿命 ( $B_{50}$ 寿命) 大约是 $B_{10}$ 寿命的5倍。

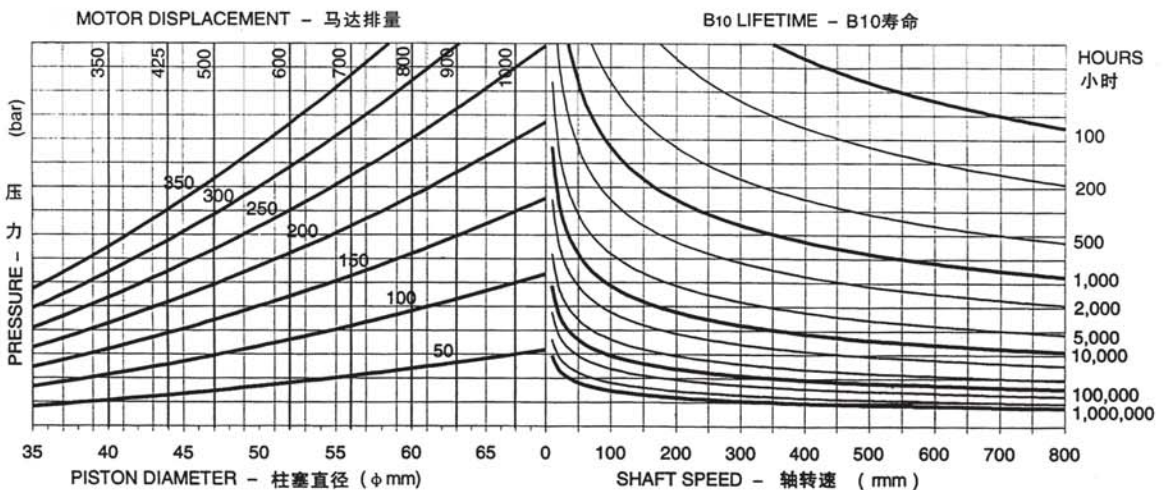

9. INM 4系列液压马达 INM4 Series Hydraulic Motors

DIMENSIONS

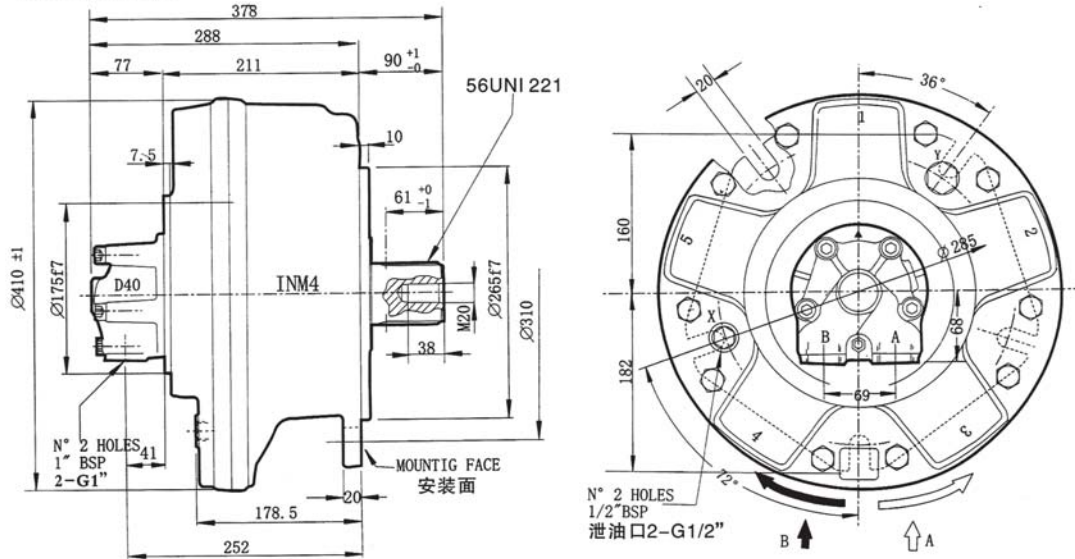

Flange and shaft dimensions are as in GM4, M5 series motors

法兰和轴承尺寸与 GM4、M5 马达系列相同

SHAFTS 轴伸型式

Splined  
矩形外花键

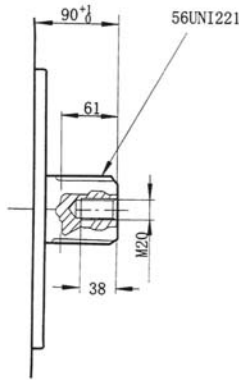

Splined A  
渐开线外花键 A

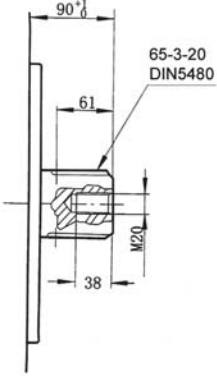

Cylindrical B  
圆柱平键 B

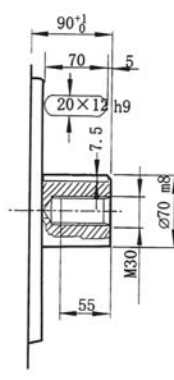

Internal spline I, IA  
内花键 I, IA

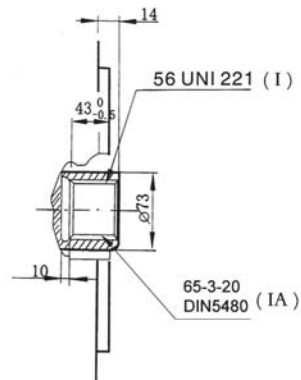

SPLINE DATA - 花键参数

| DIN | 65-3-20 DIN 5480      | 55-2-26 DIN 5482      | 55-3-17 DIN 5480      | 56 UNI 221                   |
|-----|-----------------------|-----------------------|-----------------------|------------------------------|
| d0  | Ø60.0                 | Ø52.0                 | Ø51.0                 | d1 Ø56.0 +0.030 / +0 H7      |
| d1  | Ø65.0 +0.740 / +0 H14 | Ø55.0 +0.300 / +0 H12 | Ø55.0 +0.740 / +0 H14 | d2 Ø65.0 +0.190 / +0 H11     |
| d2  | Ø59.0 +0.190 / +0 H11 | Ø50.0 +0.160 / +0 H11 | Ø49.0 +0.160 / +0 H11 | A Ø10.0 +0.028 / +0.013 F7   |
| A   | Ø5.25                 | Ø3.5                  | Ø5.25                 | d3 Ø56.0 -0.010 / -0.029 g6  |
| da  | Ø54.101 H11           | Ø46.902 H10           | Ø43.807 H11           | d4 Ø65.0 -0.100 / -0.190 d11 |
| d3  | Ø64.4 -0.190 / h11    | Ø54.5 -0.190 / h11    | Ø54.4 -0.190 / h11    | B Ø10.0 -0.028 / -0.013 f7   |
| d4  | Ø58.4 -0.740 / h14    | Ø49.0 -0.300 / h12    | Ø48.4 -0.820 / h14    |                              |
| B   | Ø6.0                  | Ø3.5                  | Ø6.0                  |                              |
| db  | Ø70.999 f8            | Ø56.953 e9            | Ø60.873 f8            |                              |

ADAPTORS  
联轴器

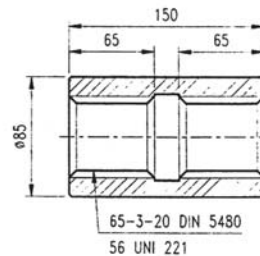

## PERFORMANCE

The graphs indicate the typical performance characteristics of the **900 cc** motor operating with mineral oil with viscosity 40 cSt at 50 °C.

## 特性曲线

下列图表为排量**900cc**的马达，在工作液采用矿物油粘度40cSt,油温50°C工作时的典型特性曲线。

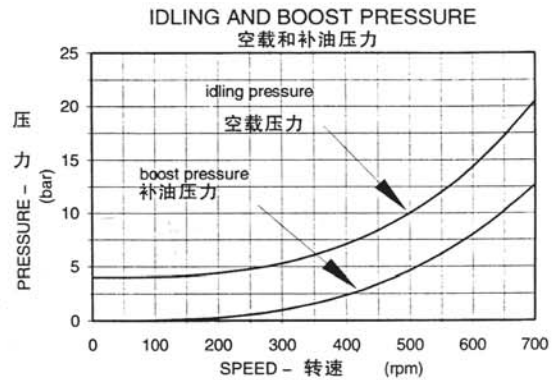
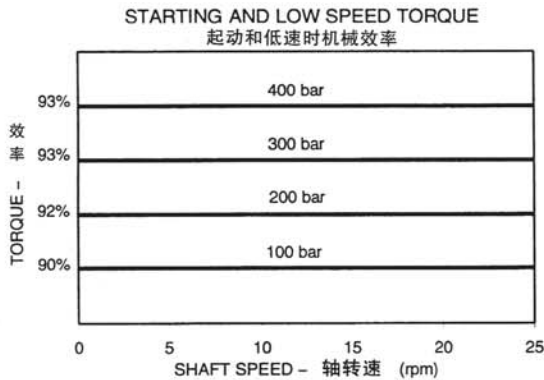
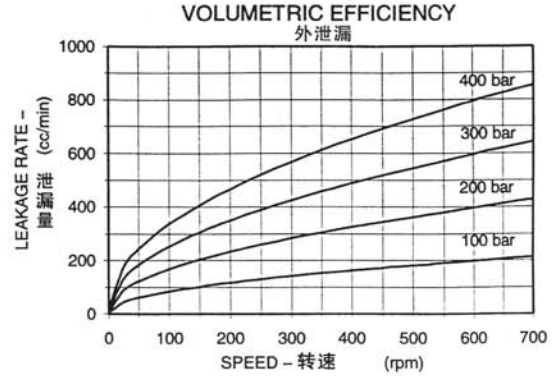
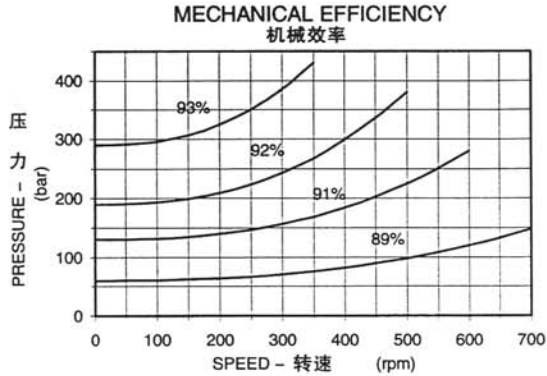

## BEARING LIFETIME

The graph refers to the motor with the standard roller bearings.  
Note that the average lifetime of a bearing ( $B_{50}$  lifetime) is approximately 5 times the  $B_{10}$  lifetime.

## 轴承寿命

该图表适用配置滚柱轴承的马达。

注意轴承平均寿命 ( $B_{50}$ 寿命) 大约是 $B_{10}$ 寿命的5倍

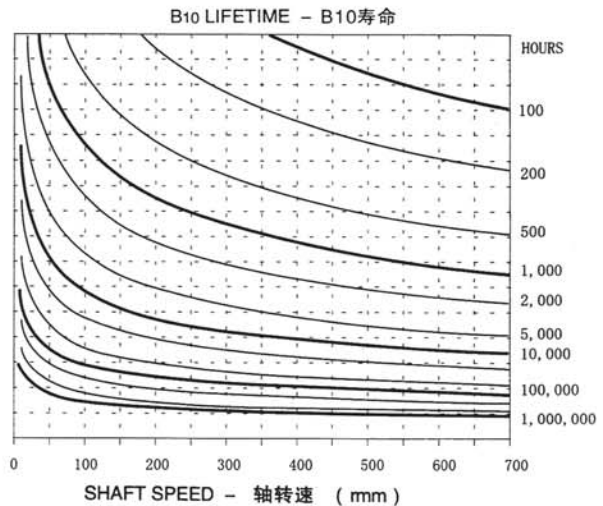
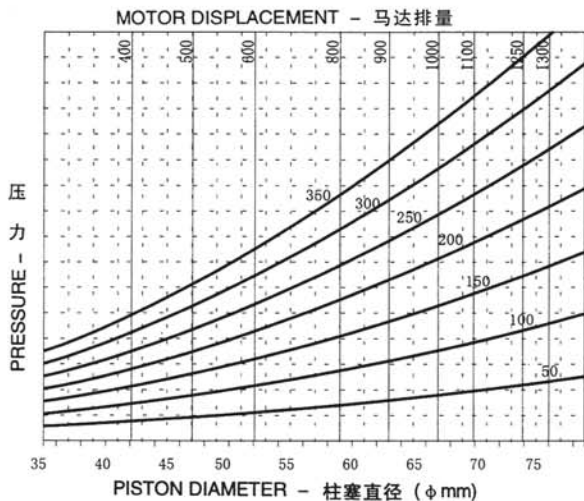

10. INM 5系列液压马达 INM5 Series Hydraulic Motors

DIMENSIONS

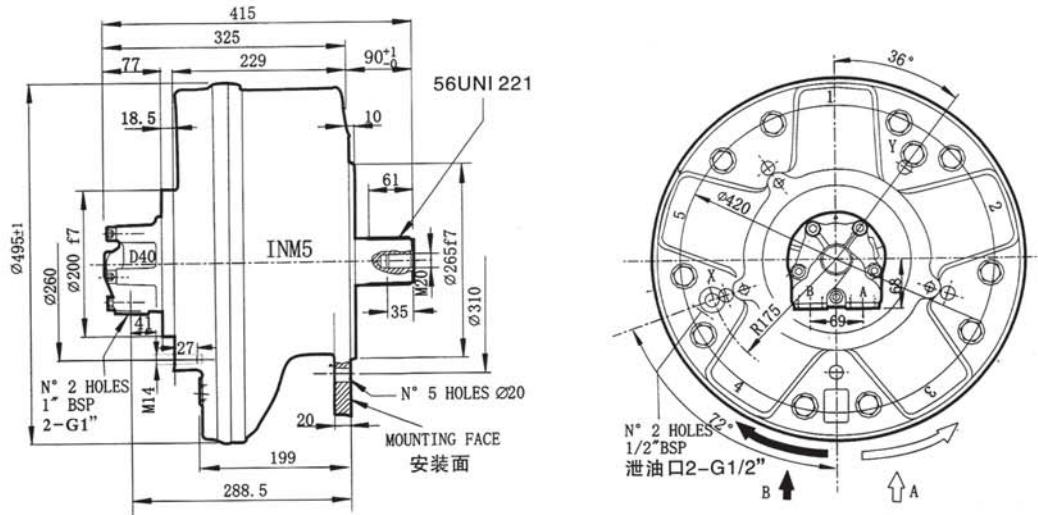

Flange and shaft dimensions are as in GM5, M5 series motors

法兰和轴承尺寸与GM5、M5 马达系列相同

SHAFTS 轴伸型式

Splined  
矩形外花键

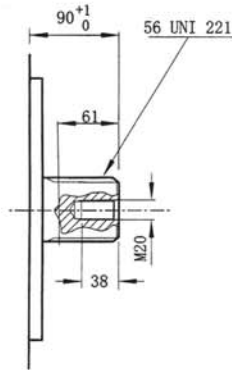

Splined A  
渐开线外花键 A

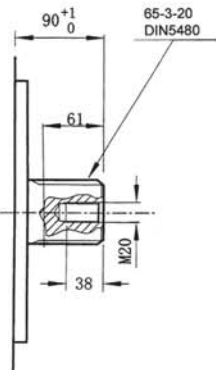

Cylindrical B  
圆柱平键 B

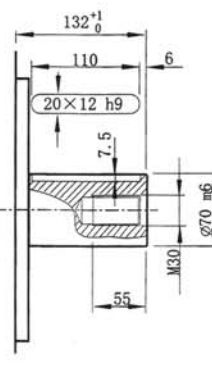

Internal spline I, IA  
内花键 I, IA

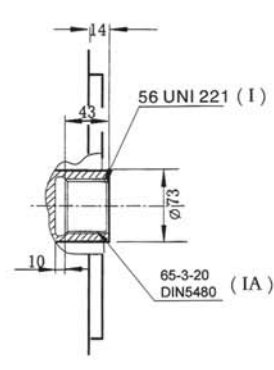

SPLINE DATA - 花键参数

| DIN | 65-3-20 DIN 5480 | 55-2-26 DIN 5482 | 55-3-17 DIN 5480 | 56 UNI221                  |
|-----|------------------|------------------|------------------|----------------------------|
| d0  | ∅60.0            | ∅52.0            | ∅51.0            | d1 ∅56.0 +0.030 H7         |
| d1  | ∅65.0 +0.740 H14 | ∅55.0 +0.300 H12 | ∅55.0 +0.740 H14 | d2 ∅65.0 +0.190 H11        |
| d2  | ∅59.0 +0.190 H11 | ∅50.0 +0.160 H11 | ∅49.0 +0.160 H11 | A 10.0 +0.028 +0.013 F7    |
| A   | ∅5.25            | ∅3.5             | ∅5.25            | d3 ∅56.0 -0.010 -0.025 g6  |
| da  | ∅54.101 H11      | ∅46.902 H10      | ∅43.807 H11      | d4 ∅65.0 -0.100 -0.190 d11 |
| d3  | ∅64.4 -0.190 h11 | ∅54.5 -0.190 h11 | ∅54.4 -0.190 h11 | B 10.0 -0.013 -0.028 f7    |
| d4  | ∅58.4 -0.740 h14 | ∅49.0 -0.300 h12 | ∅48.4 -0.620 h14 |                            |
| B   | ∅6.0             | ∅3.5             | ∅6.0             |                            |
| db  | ∅70.999 f8       | ∅56.953 e9       | ∅60.873 f8       |                            |

ADAPTORS  
联轴器

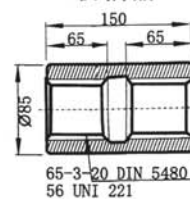

## PERFORMANCE

The graphs indicate the typical performance characteristics of the **1200cc** motor operating with mineral oil with viscosity 40 cSt at 50 °C.

## 特性曲线

下列图表为排量**1200cc**的马达，在工作液采用矿物油，粘度40cSt,油温50℃工作时的典型特性曲线。

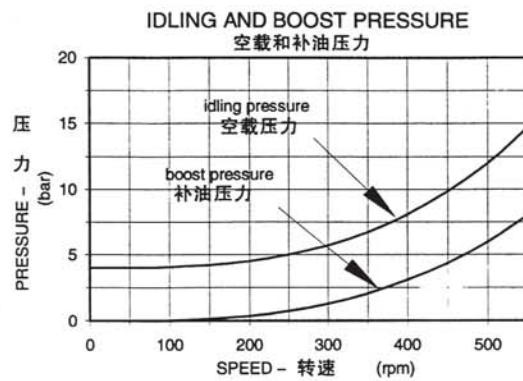
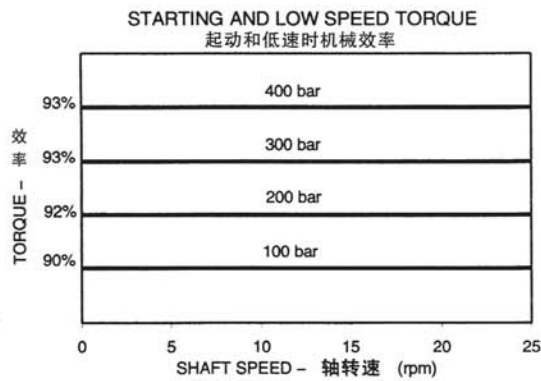
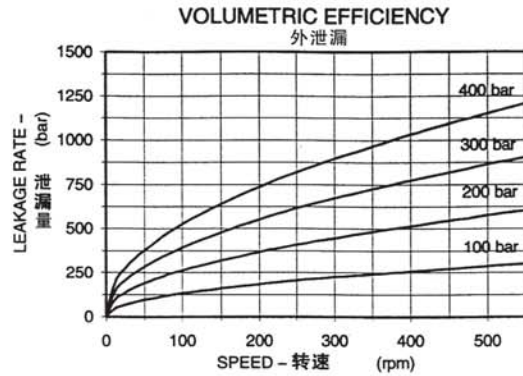
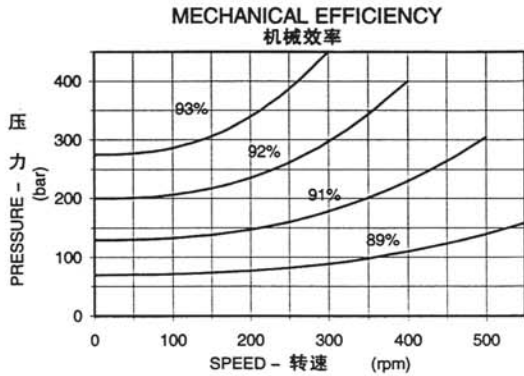

## BEARING LIFETIME

The graph refers to the motor with the standard roller bearings.

Note that the average lifetime of a bearing ( $B_{50}$  lifetime) is approximately 5 times the  $B_{10}$  lifetime.

## 轴承寿命

该图表适用配置滚柱轴承的马达。

注意轴承平均寿命 ( $B_{50}$  寿命) 大约是  $B_{10}$  寿命的5倍。

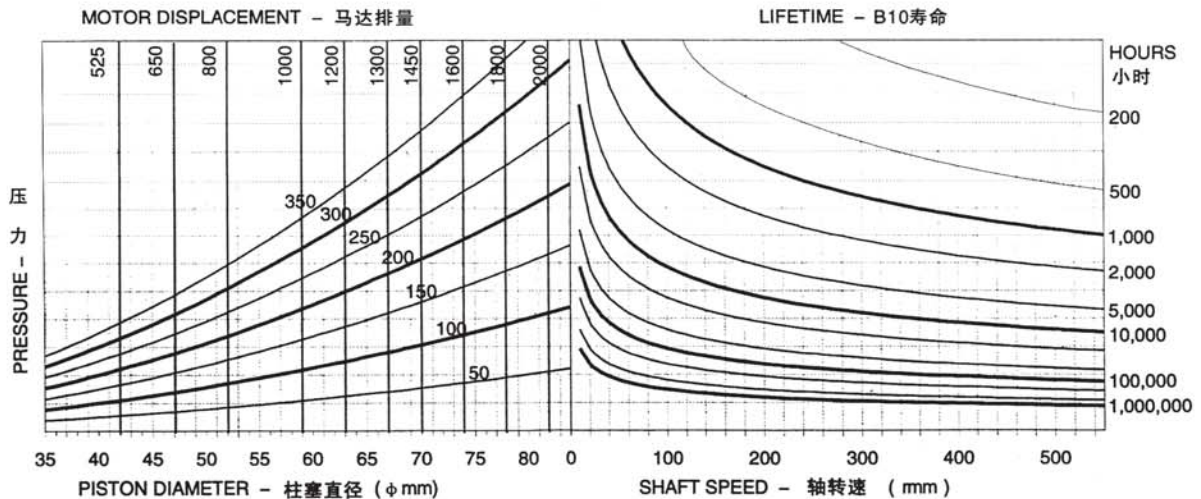

### 11. INM 6系列液压马达 INM6 Series Hydraulic Motors

#### DIMENSIONS

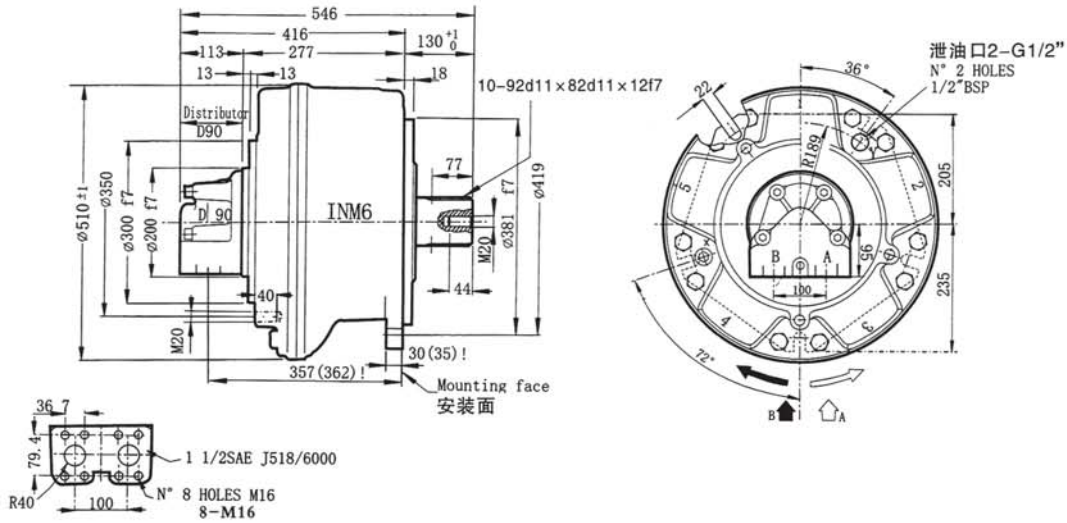

#### SHAFTS 轴伸型式

Splined  
矩形外花键、渐开线外花键 A

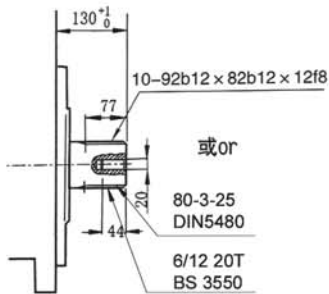

Internal spline I、IA  
内花键 I、IA  
BEARING OPTION E ONLY  
只能配置E型轴承

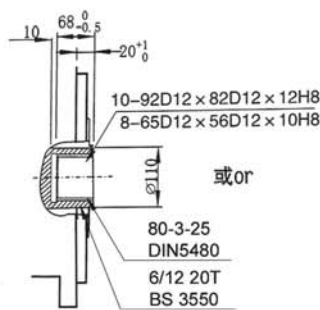

Cylindrical B  
圆柱平键 B  
BEARING OPTION E ONLY  
只能配置E型轴承

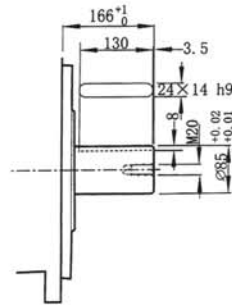

#### SPLINE DATA - 花键参数

| DIN | 80-3-25 DIN 5480        | pitch 6/12 BS 3550        |
|-----|-------------------------|---------------------------|
| d0  | ∅ 75.0                  | A ∅ 88.0 -0.047<br>-0.17  |
| d1  | ∅ 80.0 +0.870<br>+0 H14 | B ∅ 84.6                  |
| d2  | ∅ 74.0 +0.190<br>+0 H11 | C ∅ 80.0 -0.480<br>-0.070 |
| A   | ∅ 5.25                  | D ∅ 97.0 +0.082<br>+0.030 |
| da  | ∅ 68.9 H9               | E ∅ 8.12                  |
| d3  | ∅ 79.4 -0<br>-0.190 h11 |                           |
| d4  | ∅ 73.4 -0<br>-0.870 h14 |                           |
| B   | ∅ 6-0                   |                           |
| db  | ∅ 85.9 f8               |                           |

#### ADAPTORS 联轴器

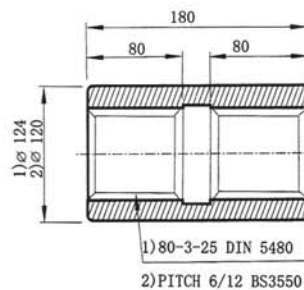

## PERFORMANCE

The graphs indicate the typical performance characteristics of the 2500cc motor operating with mineral oil with viscosity 40 cSt at 50 °C.

## 特性曲线

下列图表为排量2500cc的马达，在工作液采用矿物油，粘度40cSt,油温50°C工作时的典型特性曲线。

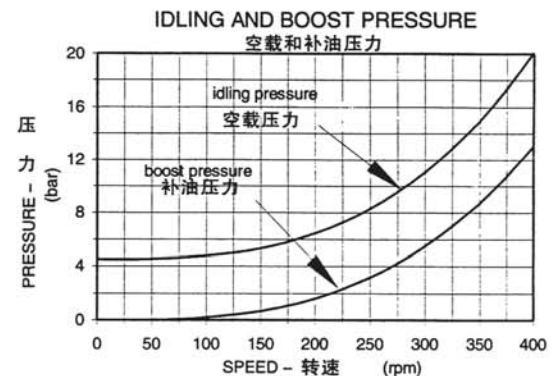
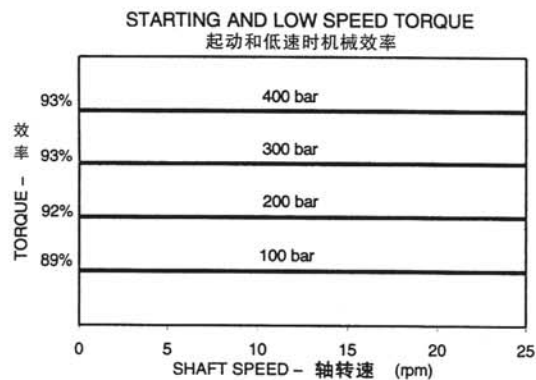
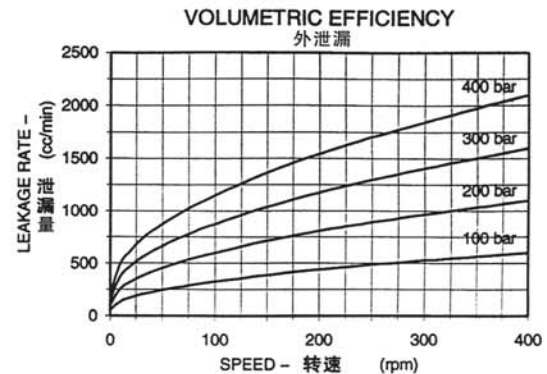
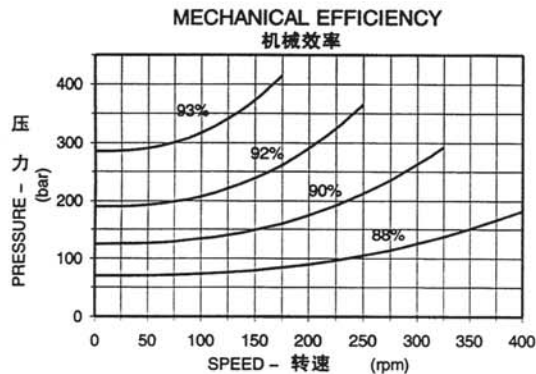

## BEARING LIFETIME

The graph refers to the motor with the standard spherical roller bearings.

Note that the average lifetime of a bearing ( $B_{50}$  lifetime) is approximately 5 times the  $B_{10}$  lifetime.

## 轴承寿命

该图表适用配置滚柱轴承的马达。

注意轴承平均寿命 ( $B_{50}$ 寿命) 大约是 $B_{10}$ 寿命的5倍。

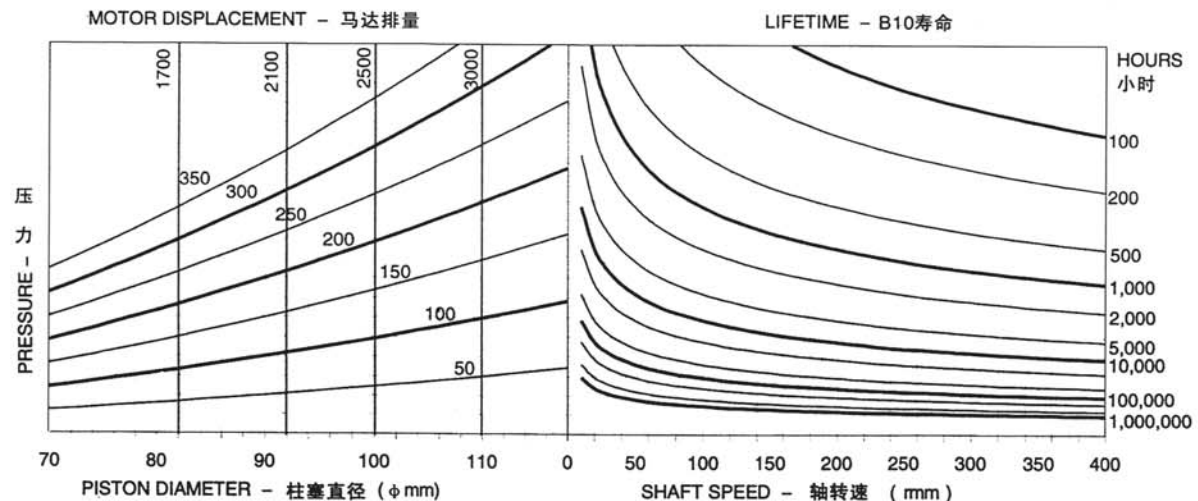



12. INM7系列液压马达安装连接尺寸图  
INM7 SERIES HYDRAULIC DIMENSIONS OF CONNECTION

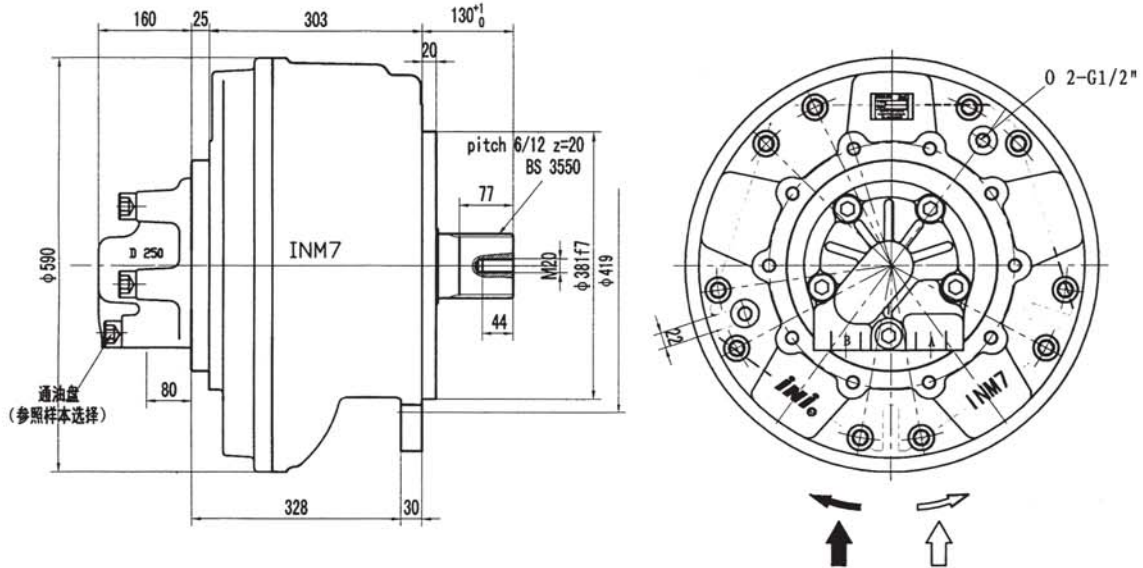

输出轴样式 SHAFTS

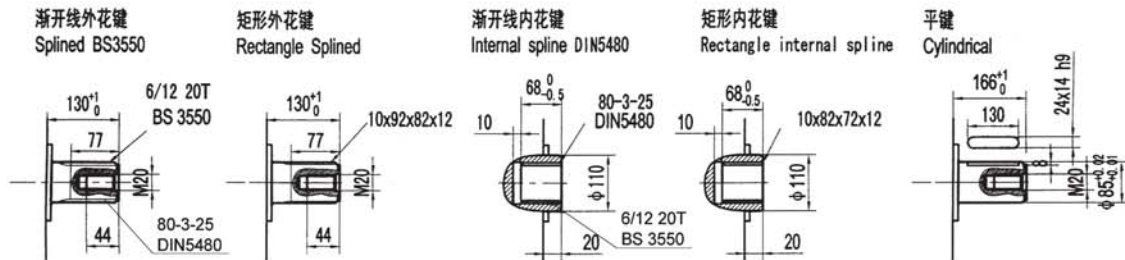

花键参数 SPLINE DATA

|  | 80-3-25 DIN 5480 |            | pitch 6/12 BS 3550                           |
|--|------------------|------------|--|
|  | d0               | φ 75.0     | A φ 88.0 <sup>-0.047</sup> <sub>-0.17</sub>  |
|  | d1               | φ 80.0 H14 | B φ 84.6                                     |
|  | d2               | φ 74.0 H11 | C φ 80.0 <sup>-0.480</sup> <sub>-0.070</sub> |
|  | A                | φ 5.25     | D φ 97.0 <sup>+0.082</sup> <sub>+0.030</sub> |
|  | da               | φ 68.9 H9  | E φ 8.12                                     |
|  | d3               | φ 79.4 h11 |  |
|  | d4               | φ 73.4 h14 |  |
|  | B                | φ 6.0      |  |
|  | db               | φ 85.9 f8  |  |
|  |                  |            |  |